

THE NAILER[®]

Better Than A Stud!



US Patent 5,581,964

Drywall Backer for Supporting Interior Drywall Corners

The Small Item With
The Big Impact!

- Replaces wood & metal backing & awkward drywall clips
- Install & block 2,000 SQ. FT. in only three hours
- Reduce call backs due to truss uplift
- Gain the competitive advantage
- Saves money while building green
- Hard fastens to both the stud and the drywall
- Provides substantial energy savings
- Galvanized steel or 100% recycled HDPE plastic

Help Line: 1-800-280-2304

Watch the Video: www.TheNailer.com

THE NAILER[®]

Better Than A Stud!

The Nailers are attached to the vertical end stud on the bisecting walls or top plate 16" on center.

When fastening the galvanized steel Nailer to a wood framing member use one 1-1/4" - #6 or #8 course threaded drywall screw.

When fastening the galvanized steel Nailer to a steel framing member use one Tex or component screw.

The recommended placement of the screw in the galvanized Nailer is in the center hole.

When fastening the HDPE plastic Nailer to a wood framing member use: two 1/2" staples (min.) with a 1/2" crown from an Arrow T-150 staple gun (or the like); one 1-1/4" drywall nail; or a 1" roofing nail.

The staples, nails or screws will be applied through the down stem of The Nailer.

In the wall to wall application, The Nailer is installed 16" on center from the top plate. By adding the thickness of the lid to the measurement, i.e. 48 5/8", this will allow both sheets to fasten to one Nailer at the seam.

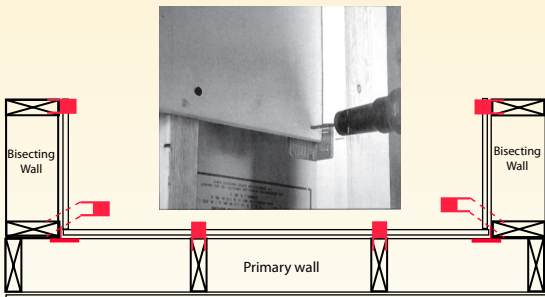
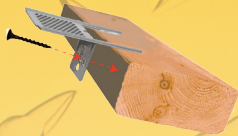

Help Line: 1-800-280-2304

Watch the Video: www.TheNailer.com